



User Manual



Smart Tools



All Software & files can be downloaded from
<http://www.milesight.com/support/download.asp>

Better Inside, More in Sight

Milesight Technology | www.milesight.com



QUICK START GUIDE

Weather-proof Mini Dome Network Camera Series



IP VIDEO SURVEILLANCE

Table of Content

1. Quick Installation Steps.....	2
2. Hardware Overview.....	5
3. How to Connect the Water-proof Connector.....	6
4. Assigning an IP Address by Using Smart Tools.....	6
5. Assigning an IP Address via Browser.....	7
6. Accessing from the Web Brower.....	7

1. Quick Installation Steps

Remove the dome cover, loosen the setscrew and take the bracket off.

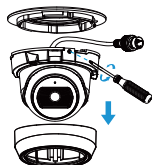

Fix the bracket in the position where the camera is intended to be installed. Wall Mount (A71) is available for installation.

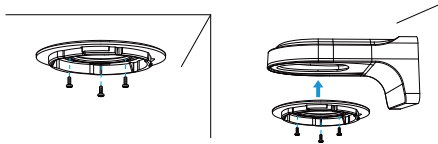

Weather-proof Mini Dome Network Camera

Step1: Connect the cables, rotate the camera to bracket and tighten the setscrew;

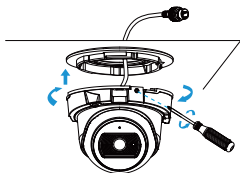

Step2: Loosen clamp screw and adjust shooting direction, tighten clamp screw;

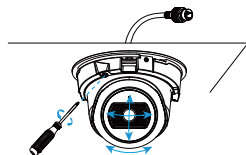

Step3: Attach the dome cover.

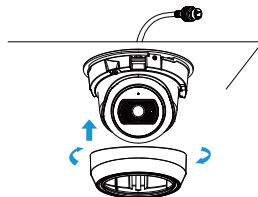

AF Motorized Mini Dome Network Camera

Step1: Loosen the shoulder screw and open the dome body. Take out the waterproof connector, pull out connector center. Place Piercing Cap on Ethernet Connector, and put cable through from large opening to small one. Finally, plug connector into Cable Entry Hole and rotate camera to bracket clockwise, then secure setscrew;

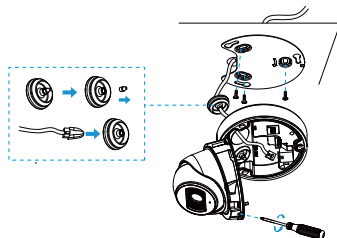

Step2: Connect the cables to respective connectors, then attach camera body to the base and secure shoulder screw;

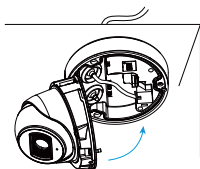

Step3: Loosen clamp screw, then tighten it after adjusting shooting direction;

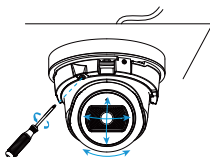

Step4: Attach the dome cover.

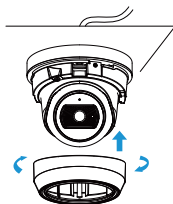

2. Hardware Overview

Weather-proof Mini Dome Network Camera

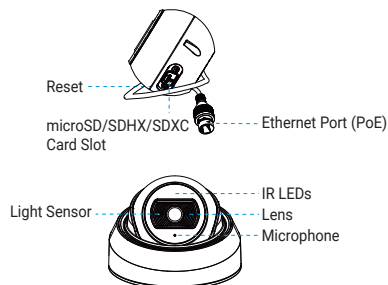

AF Motorized Mini Dome Network Camera

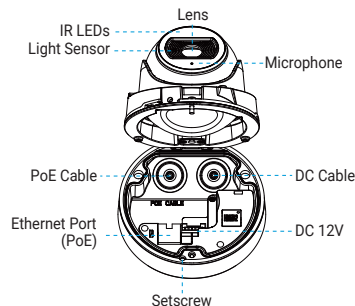

4. How to Connect the Water-proof Connector

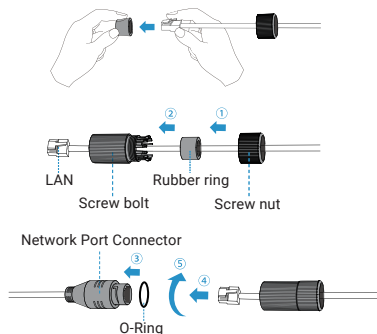

Step1: Get the network cable through the screw nut, rubber ring and the screw bolt;

Step2: Insert the rubber ring into the screw bolt;

Step3: Connect the screw nut to the screw bolt;

Step4: Place the O-Ring on the network port connector;

Step5: Connect the RJ45 to the network port connector, tighten the screw bolt and the connector.

Note:

Please tightly wrapped all cable-out interface with adhesive tape at last to prevent them from water.

5. Assigning an IP Address by Using Smart Tools

Smart Tools is a software tool which can automatically detect multiple online Milesight network cameras in the LAN, set IP addresses, and manage firmware upgrades. It's recommended to use when assigning IP addresses for multiple cameras.

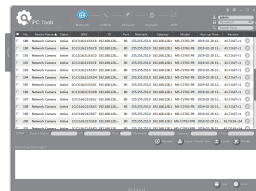

The steps to change the IP of cameras are as below:

1) Start Smart Tools, click the IPC Tools page, then enter the device information, such as IP address, MAC address, Port number, Netmask, and Gateway, then all related Milesight network cameras in the same network that will be shown.

2) Select a camera or multiple cameras according to the MAC addresses.

3) Click "Activate" to set the password when using the cameras for the first time (Password must be 8 to 32 characters long, contain at least one number and one letter), and set three security questions (If you forget the password, you can reset the password by answering three security questions correctly).

4) Type the user name and password you set, change the IP address or other network values, and then click "Modify" button.

5) By double clicking the selected camera or the browser of interested camera, you can access the camera via web browser directly.

More usage of Smart Tools, please refer to the "Smart Tools User Manual".

6. Assigning an IP Address via Browser

If the network segment of the computer and that of the camera are different, please add some 192.168.5.x(255.255.255.0) for your PC to get access to your cameras, more details can be found on "Milesight Network Camera Quick Start".

7. Accessing from the Web Browser

The camera can be used with the most standard operating systems and browsers. The recommended browsers are Internet Explorer, Firefox, Chrome, Safari. More information about the plugin installation, please refer to the troubleshooting:

5.Milesight-Troubleshooting-Plugin Installation on Windows-IPC

6.Milesight-Troubleshooting-Plugin Installation on MAC

Weather-proof Mini Dome

Thank you
for choosing
Milesight Product

Milesight Technology